

DIN 934 similar to ISO 4032

Hexagon nuts

External hex

Brass | Cr(VI)-free | Metric thread

Further information: DIN-standard has been withdrawn | changed spanner widths for M10, M12, M14 and M22 | the fine thread has been transferred to ISO 8673

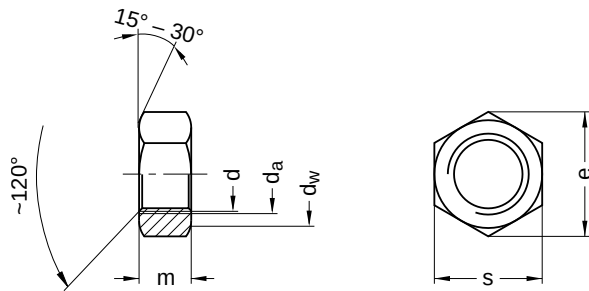

Diameter (d)	d _a		d _w min.	e min.	m		s		Pitch (P)
	min.	max.			min.	max.	min.	max.	
M 2	2.0	2.30	3.2	4.32	1.35	1.6	3.82	4.0	0.40
M 2.5	2.5	2.50	4.1	5.45	1.75	2.0	4.82	5.0	0.45
M 3	3.0	3.45	4.5	6.01	2.15	2.4	5.32	5.5	0.50
M 3.5	3.5	4.00	5.0	6.58	2.55	2.8	5.82	6.0	0.60
M 4	4.0	4.60	5.8	7.66	2.90	3.2	6.78	7.0	0.70
M 5	5.0	5.75	6.8	8.79	3.70	4.0	7.78	8.0	0.80
M 6	6.0	6.75	8.8	11.05	4.70	5.0	9.78	10.0	1.00
M 8	8.0	8.75	11.3	14.38	6.14	6.5	12.73	13.0	1.25
M 10	10.0	10.80	15.3	18.90	7.64	8.0	16.73	17.0	1.50
M 12	12.0	13.00	17.2	21.10	9.64	10.0	18.67	19.0	1.75
M 14	14.0	15.10	20.2	24.49	10.30	11.0	21.67	22.0	2.00
M 16	16.0	17.30	22.2	26.75	12.30	13.0	23.67	24.0	2.00
M 18	18.0	19.50	25.3	29.56	14.30	15.0	26.16	27.0	2.50
M 20	20.0	21.60	28.2	32.95	14.90	16.0	29.16	30.0	2.50
M 22	22.0	23.70	29.5	35.03	16.90	18.0	31.00	32.0	2.50
M 24	24.0	25.90	33.2	39.55	17.70	19.0	35.00	36.0	3.00
M 27	27.0	29.10	38.0	45.20	20.70	22.0	40.00	41.0	3.00
M 30	30.0	32.40	42.7	50.65	22.70	24.0	45.00	46.0	3.50

All technical data refer to the measure mm

