

Height Adjusting Cylinders

23310.0172



Product Description

For increasing the clamping height of down-thrust clamps EH 23310, the height adjusting cylinders can be used. They are also used in combination with seating pins (EH 22680.), pins (EH 22690.) and self-aligning pads (EH 22730. - EH 22741.).

Material

- Steel, case-hardened, blackened, ground

More information

Further products

- Seating Pins, ribbed or pointed
- Seating Pins, pin shape
- Pins
- Seating Pins, adjustable
- Self-Aligning Pads
- Self-Aligning Pads, with hard metal ball, ribbed
- Self-Aligning Pads, self-resetting
- Self-Aligning Pads, with hard metal ball, ribbed and self-resetting
- Self-Aligning Pads, adjustable
- Self-Aligning Pads, adjustable with self-resetting

Drawing

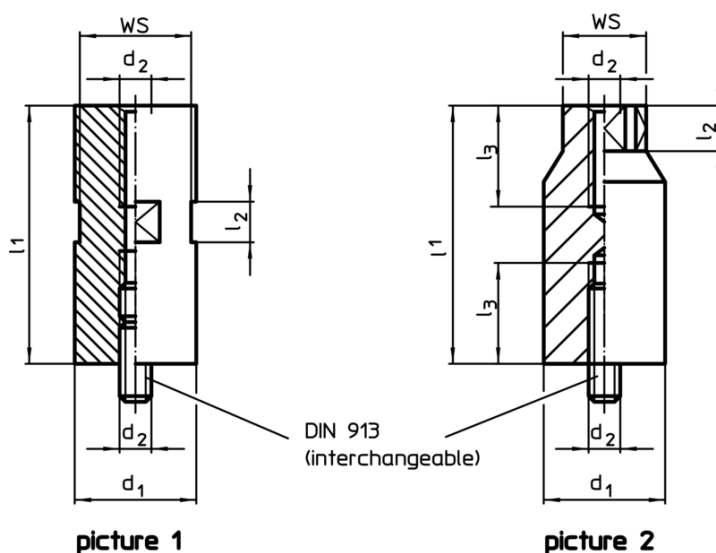

Order information

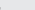
Dimensions				WS		Art. No.
d ₁ h9	l ₁ ±0,01	d ₂	l ₂			
[mm]				[mm]	[g]	
picture 1						
60	200	M20	20	55	3623	23310.0172

Application example

